

BEHIND NECK-II

by **Nautilus**

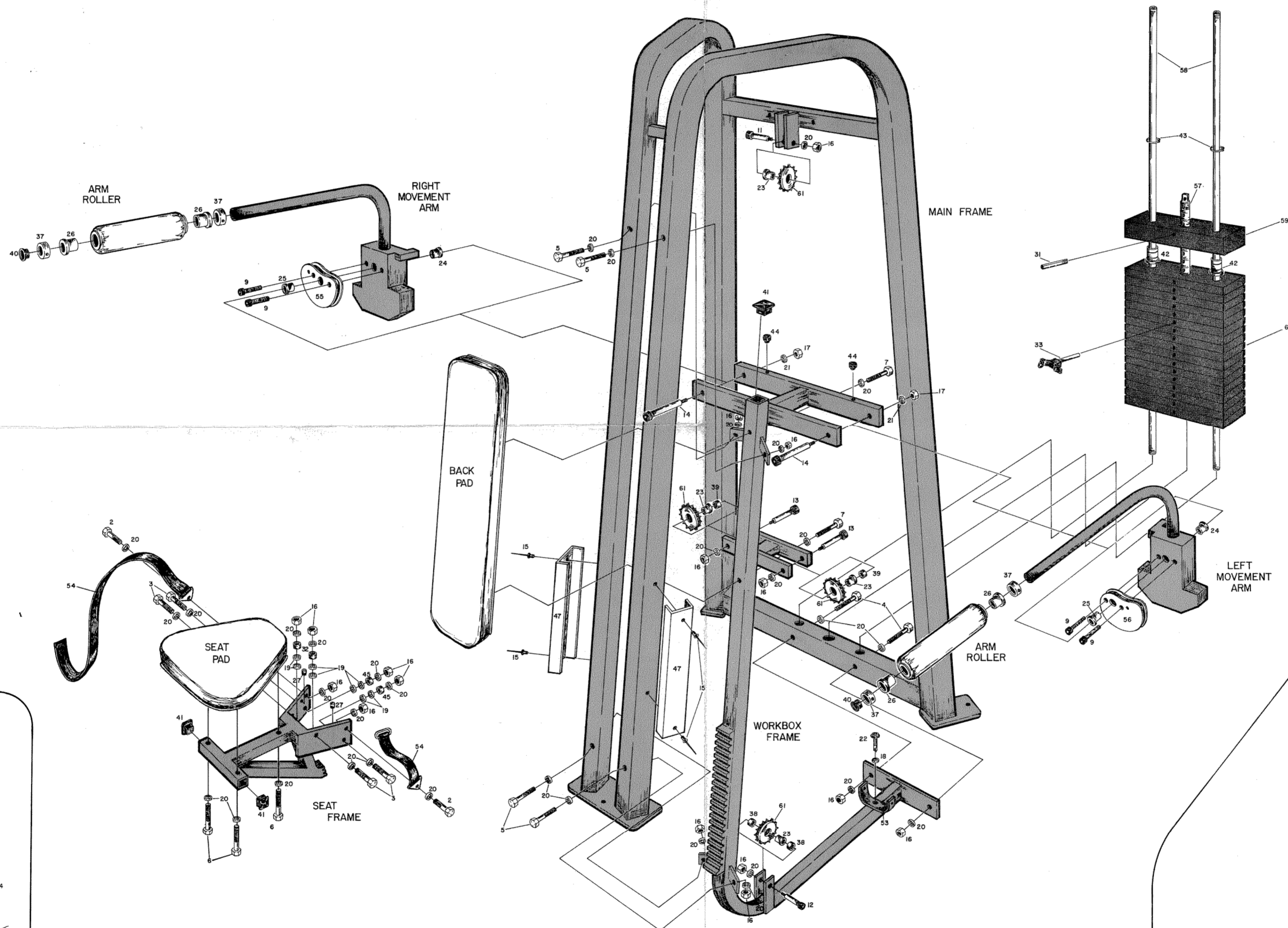

1	1/4 x 1/2	STOVE BOLT	35	#2040	COUPLE LINK
2	3/8 x 1	HEX HEAD BOLT	36	CHAIN ADJ.	ASSEMBLY
3	3/8 x 1 1/2	"	37	1 1/4	LOCK COLLAR
4	3/8 x 2 1/4	"	38	1/2 x 3/16	PIPE SPACER
5	3/8 x 2 3/4	"	39	1/2 x 1/4	"
6	3/8 x 3	"	40	7/8	HOLE PLUG
7	3/8 x 4 1/2	"	41	1 1/4 x 1 1/4	"
8	1/4 x 1 1/4	ALLEN CAP SCREW	42	LINEAR BEARING	
9	1/2 x 1	"	43	W-125	SNAP RING
10	1/2 x 1 1/4	SHOULDER BOLT	44	1/2	FLAT RUBBER STOP
11	1/2 x 1 3/4	"	45	9/16	SEAT BEARING
12	1/2 x 2	"	46	REDIRECTIONAL BRACKET	
13	1/2 x 2 1/2	"	47	16"	ALUMINUM CHANNEL
14	3/4 x 5	"	48	SIDE, LEFT	L.R. SHIELD
15		BLIND RIVET	49	SIDE, RIGHT	L.R. SHIELD
16	3/8	LOCK NUT THIN	50	L.R.	ACCESS PANEL
17	5/8	"	51	RIGHT	WORKBOX SHIELD
18	1/4	FLAT WASHER	52	LEFT	WORKBOX SHIELD
19	3/8	"	53	L.R.	SIDE SHIELD BRACKET
20	3/8	LOCK WASHER	54	MEDIUM	SEAT BELT
21	5/8	"	55	BN - II	RIGHT CAM
22	1/8 x 1/2	SELF-TAPPING SCREW	56	BN - II	LEFT CAM
23	1/2 x 3/4 x 1	BRASS BUSHING	57	19-HOLE	WEIGHT STACK PIN
24	3/4 x 1 x 1	"	58	49 3/4"	GUIDE ROD
25	3/4 x 1 x 1 1/2	"	59	20 lb.	TOP WEIGHT
26	1 1/4 x 1 1/2 x 1 1/4	"	60	10 lb.	BOTTOM WEIGHT
27	3/8 x 3/8	BU - 2 A	61	19 TC - 2	SPROCKET
28		CBR #1	62	14 TC - 2	"
29		CBR #12	63	78"	#40 SINGLE CHAIN
30	1/4	CAM NUT	64	93"	#40
31	3/8 x 3	ROLL PIN			
32	#4	THICK BEARING			
33	#10	SELECTOR PIN			
34	#40	SINGLE MASTER LINK			

