

# LEG ABDUCTOR

by Nautilus

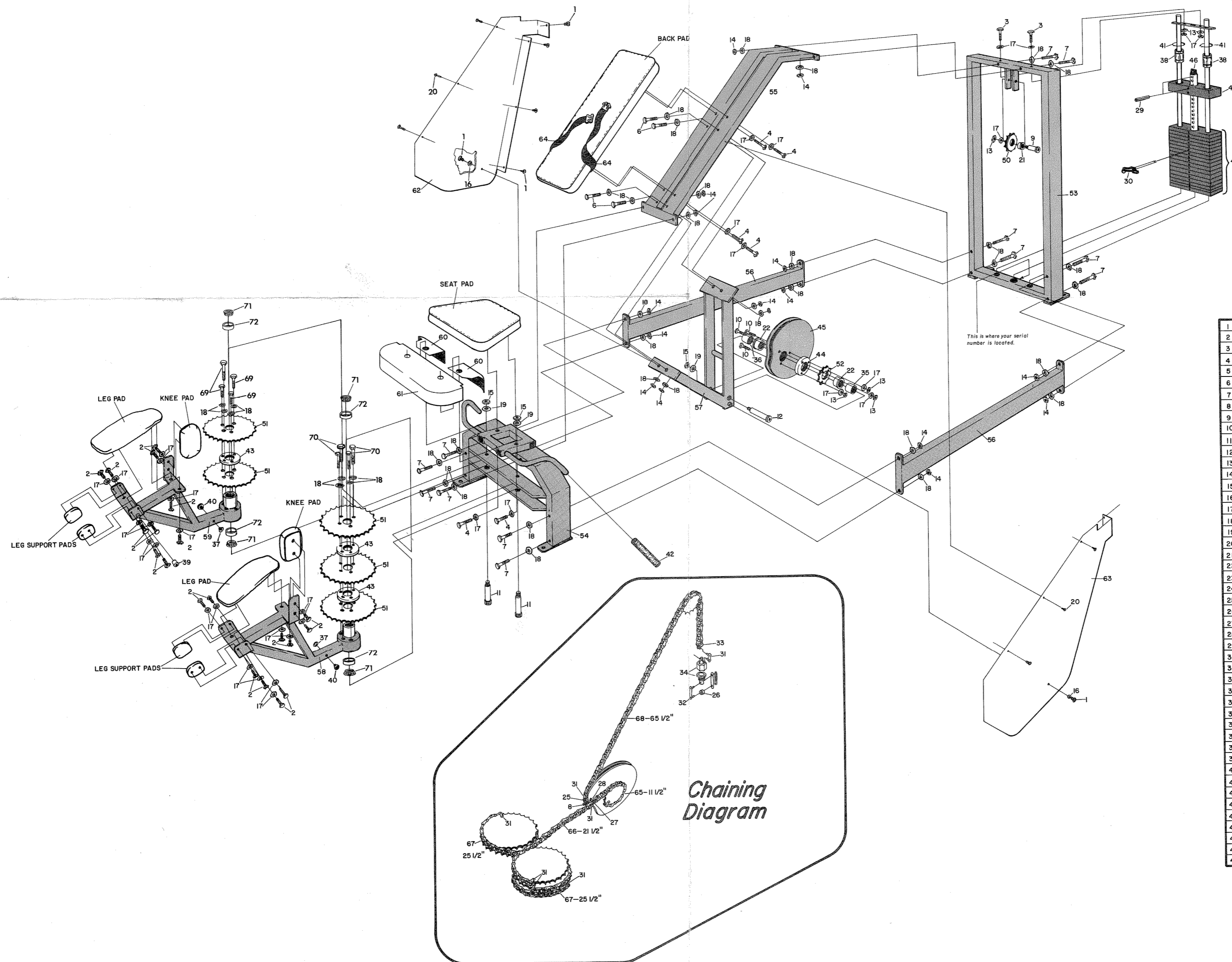

1	1/4x1/2 STOVE BOLT	49	10lb. BOTTOM WEIGHT
2	3/8x1 HEX HD BOLT	50	19TC-2 SPROCKET
3	3/8x2 1/2 " " "	51	54TA-6 " "
4	3/8x3 " " "	52	23TA-2 " "
5	1/2x1 3/4 " " "	53	BACK FRAME
6	1/2x2 1/2 " " "	54	FRONT FRAME
7	1/2x3 3/4 " " "	55	TOP FRAME
8	1/4x1/4 ALLEN CAP SCREW	56	SIDE RAIL
9	1/2x1/2 SHOULDER BOLT	57	WORK BOX
10	3/8x2 1/4 HEX HD BOLT GR. 8	58	LEFT MOVEMENT ARM
11	3/4x5 1/2 SHOULDER BOLT	59	RIGHT MOVEMENT ARM
12	3/4x6 " " "	60	FRONT INNER FRAME SHIELD
13	3/8 THIN ELASTIC LOK NUT	61	FRONT OUTER FRAME SHIELD
14	1/2 " " "	62	RIGHT SIDE SHIELD
15	5/8 " " "	63	LEFT SIDE SHIELD
16	1/4 INTERNAL LOK WASHER	64	SEAT BELT
17	3/8 " " "	65	11 1/2" SINGLE CHAIN
18	1/2 " " "	66	21 1/2" " " "
19	5/8 " " "	67	25 1/2" " " "
20	1/8x1/2 SELF-TAPPING SCREW	68	65 1/2" " " "
21	1/2x3/4x1 BRASS BUSHING	69	1/2 x 1 3/4 HEX HD BOLT GR. 8
22	3/4x1x1 " " "	70	1/2 x 2 1/2 " " "
23	3/4x1x1 1/2 " " "	71	3/4 I.D. BEARING CONE
24	BU-3	72	BEARING RACE (CUP)
25	CBR-1		
26	CBR-12		
27	CBR-15		
28	1/4 CAM NUT		
29	3/8x3 ROLL PIN		
30	# 10 SELECTOR PIN		
31	# 40 SINGLE MASTER LINK		
32	# 2040 SINGLE COUPLER LINK		
33	# 40 SINGLE HALF LINK		
34	CHAIN TIGHTENER		
35	3/4 x 1 PIPE SPACER		
36	3/4x1 1/2 " " "		
37	1/2 HOLE PLUG		
38	LINEAR BEARING		
39	# 18 BUMPER STOP		
40	RB-1 FLAT RUBBER BUMPER		
41	W-125 SNAP RING		
42	HAND GRIP		
43	LAB-D 25		
44	LAB 26		
45	CAM		
46	19 HOLE WEIGHT STACK PIN		
47	47 5/8 GUIDE ROD		
48	20lb. TOP WEIGHT		