

SIDE LEG CURL-II

by
Nautilus®

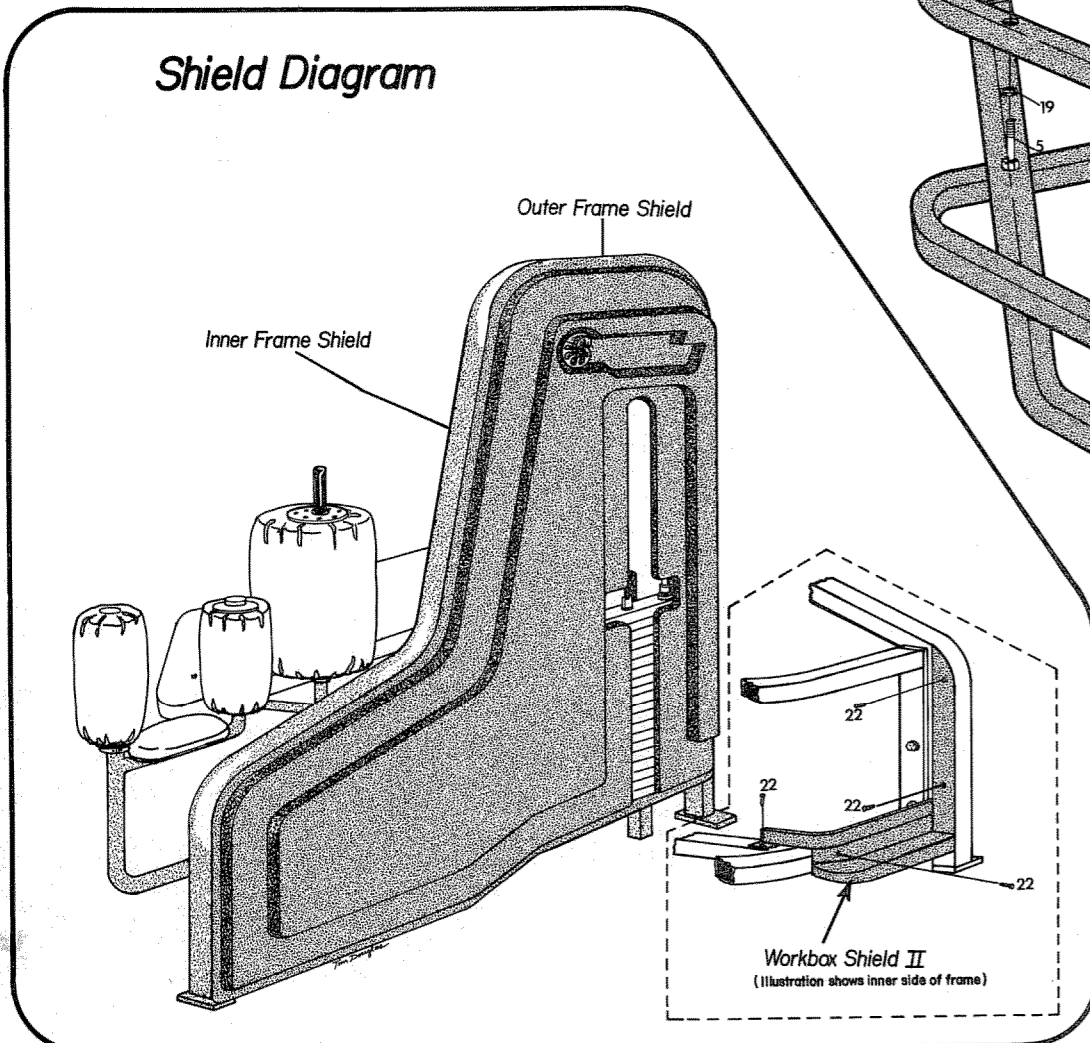
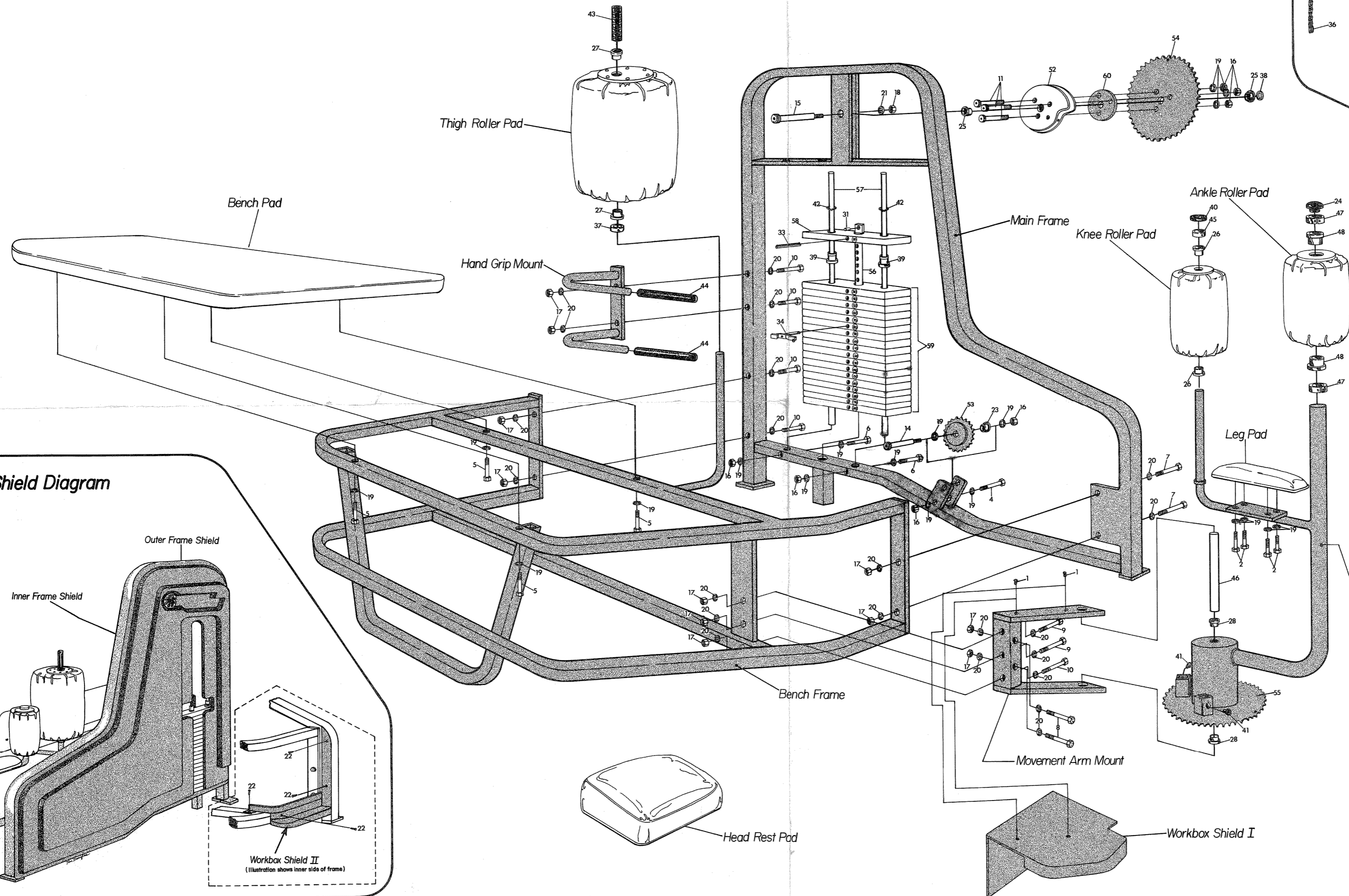
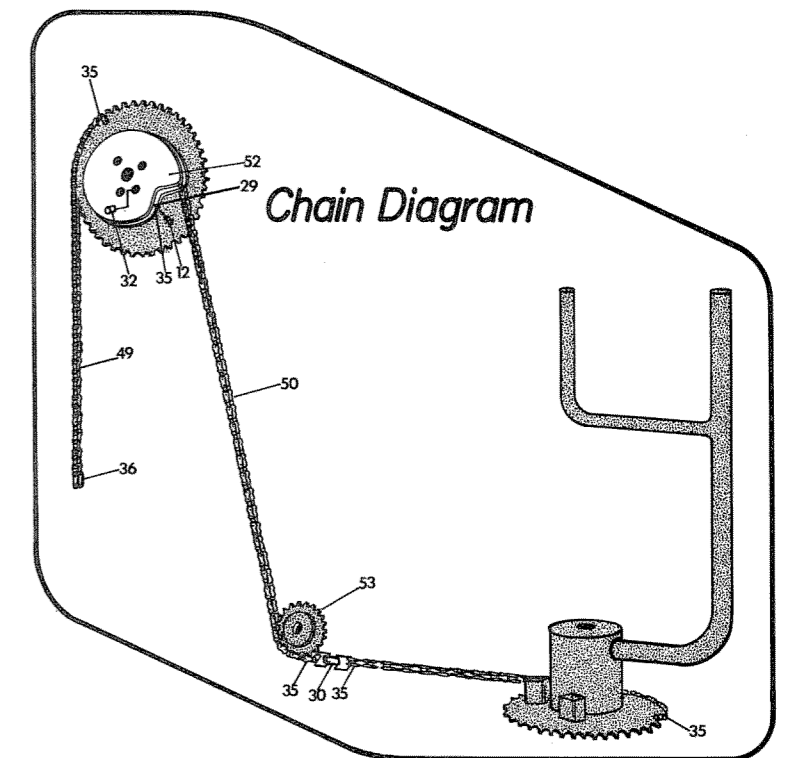

1	1/4 x 1/2 TRUSS HEAD BOLT	38	3/4 x 1/4 SPACER
2	3/8 x 3 HEX HEAD BOLT	39	LINEAR BEARING
3	3/8 x 2 " " "	40	1-1/2 VINYL CAP
4	3/8 x 2-1/4 " " "	41	1" RUBBER BUMPER
5	3/8 x 2-1/2 " " "	42	W-125 SNAP RING
6	3/8 x 3-1/2 " " "	43	1-1/8 HAND GRIP
7	1/2 x 1-1/4 " " "	44	7/8 x 1/8 x 8-3/4 HAND GRIP
8	1/2 x 2-3/4 " " "	45	1" LOK COLLAR
9	1/2 x 3-1/4 " " "	46	MOVEMENT ARM SHAFT
10	1/2 x 4 " " "	47	1-3/4 SPLIT LOK COLLAR
11	3/8 x 1-1/4 ALLEN CAP SCREW	48	1.765 x 2 x 1-1/4 BR. BSHG. (REAMED)
12	1/4 x 1-1/2 " " "	49	28-1/2" STACK CHAIN
13	1/2 " " " "	50	65-1/2" CHAIN (CAM TO CBR)
14	1/2 x 1-1/4 SHOULDER BOLT	51	20-1/2" CHAIN (CBR TO MA)
15	3/4 x 2-1/4 " " "	52	NEB. CAM
16	3/8 THIN ELASTIC LOK NUT	53	19 TC-2 SPROCKET
17	1/2 " " " "	54	60 TA-1 " "
18	5/8 " " " "	55	72 TA-8 " (WELD)
19	3/8 INTL LOK WASHER	56	WEIGHT STACK PIN
20	1/2 " " " "	57	GUIDE RODS
21	5/8 " " " "	58	10 LB. TOP WEIGHT
22	1/8 x 1/2 SELF TAPPING SCREW	59	10 LB. BOTTOM WEIGHTS
23	1/2 x 3/4 x 1 BRASS BUSHING	60	3 x 3/16 SPACER
24	MUSHROOM CAP		
25	3/4 x 1 x 3/4 BRASS BUSHING		
26	1 x 1-1/4 x 3/4 " " "		
27	1-1/8 x 3/8 x 3/4 " " "		
28	1-1/4 x 1/2 x 3/4 " " "		
29	CBR # 1		
30	CBR # 2		
31	CBR # 12		
32	1/4 CAM NUT		
33	3/8 x 3 ROLL PIN		
34	#10 SELECTOR PIN		
35	#40 MASTER LINK		
36	#2040 COUPLED LINK		
37	1-1/8 LOK COLLAR		